

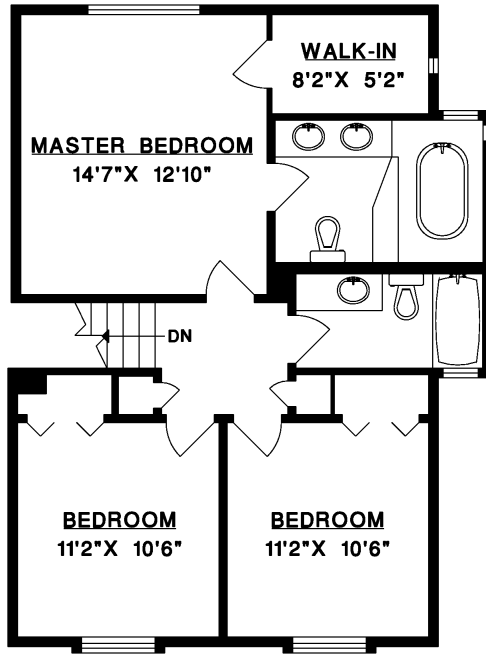

4765 MEADFIELD ROAD, WEST VANCOUVER

MAIN FLOOR 771 SQ.FT.  
 UPPER FLOOR 779 SQ.FT.  
 LOWER FLOOR 892 SQ.FT.  
 LIVABLE 2,442 SQ.FT.  
 GARAGE 439 SQ.FT.  
 PATIO 274 SQ.FT.



UPPER FLOOR

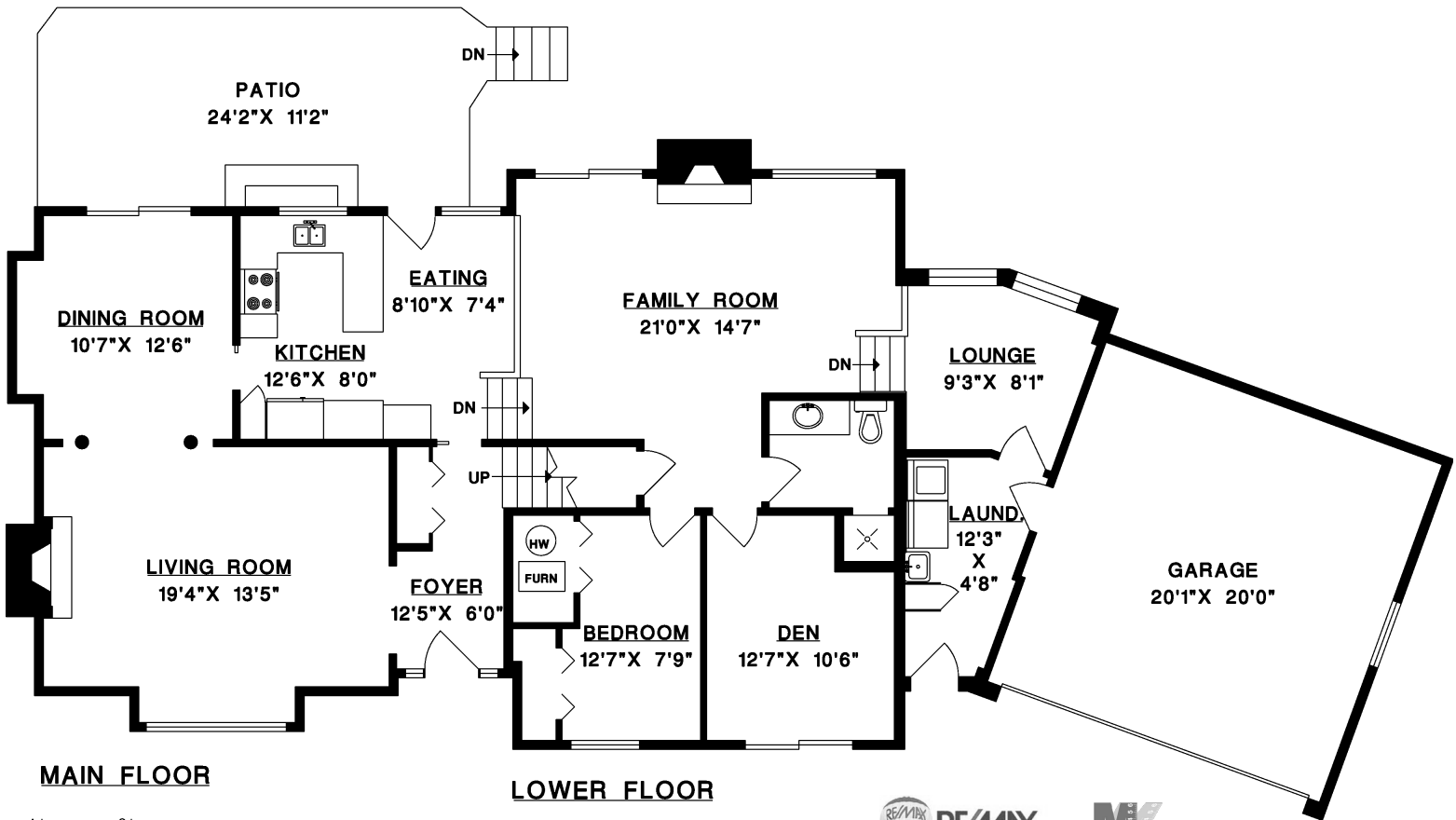

MAIN FLOOR

LOWER FLOOR

