

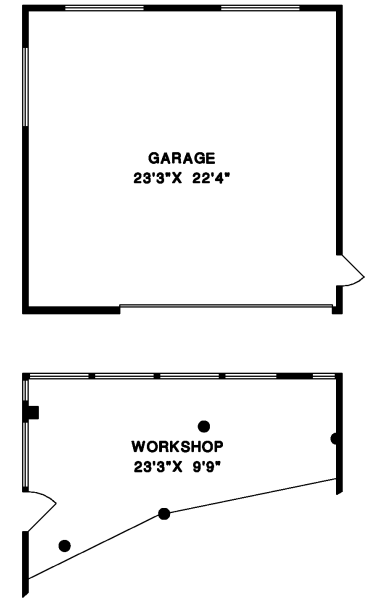

## 6 MONTIZAMBERT WYND, WEST VANCOUVER

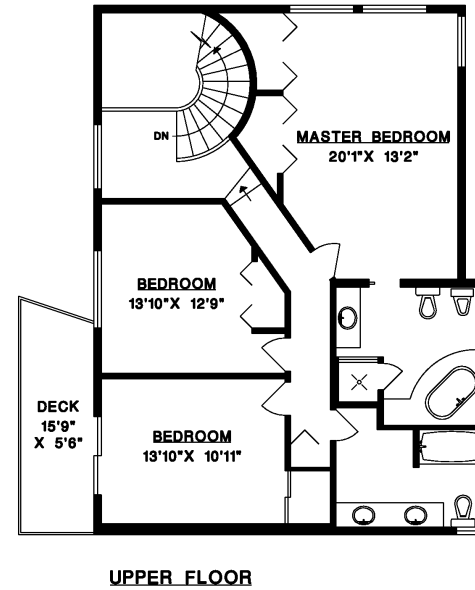

MAIN FLOOR	1,811 SQ.FT.
UPPER FLOOR	1,095 SQ.FT.
LOWER FLOOR	958 SQ.FT.
<b>LIVABLE</b>	<b>3,864 SQ.FT.</b>
COACH HOUSE	1,488 SQ.FT.
DECKS	622 SQ.FT.
GARAGES	1,092 SQ.FT.
WORKSHOP	264 SQ.FT.

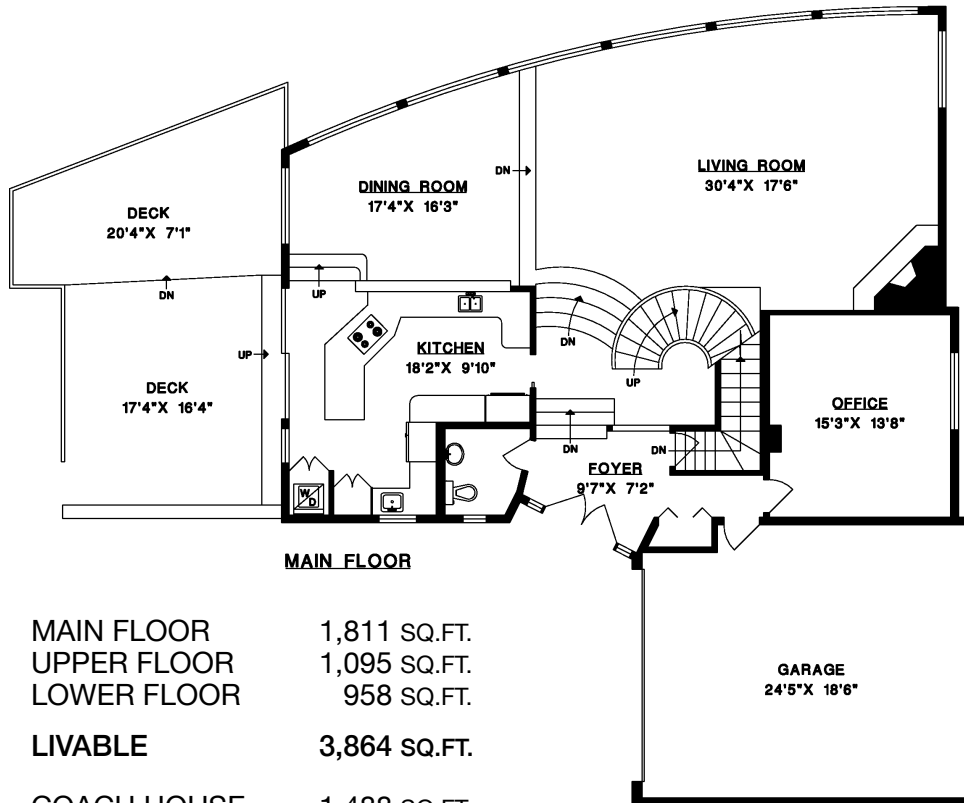